



Level 6/299 Sussex Street Sydney NSW

Ideally located in the populated business precinct with high volume of traffic, these partitioned offices (69m2, 70m2, 90m2 and 95m2) will be ready for occupation end of April 2017.

It also features:

- \$490/m2 net rate, \$143/m2 outgoing.
- Individual carspace available for lease with extra cost
- Excellent natural light
- High Ceiling
- Air conditioning
- Mins walk to Town Hall, Darling Harbor and public transports

299-305 Sussex Street is located on the western side of Sussex Street between Bathurst & Liverpool Street. The property is conveniently located in the middle of the major

Building Size : 69 sqm
Land Size : 69 sqm
View : <https://www.drakeproperty.com/lease/nsw/sydney-city/sydney/commercial/offices/5723757>

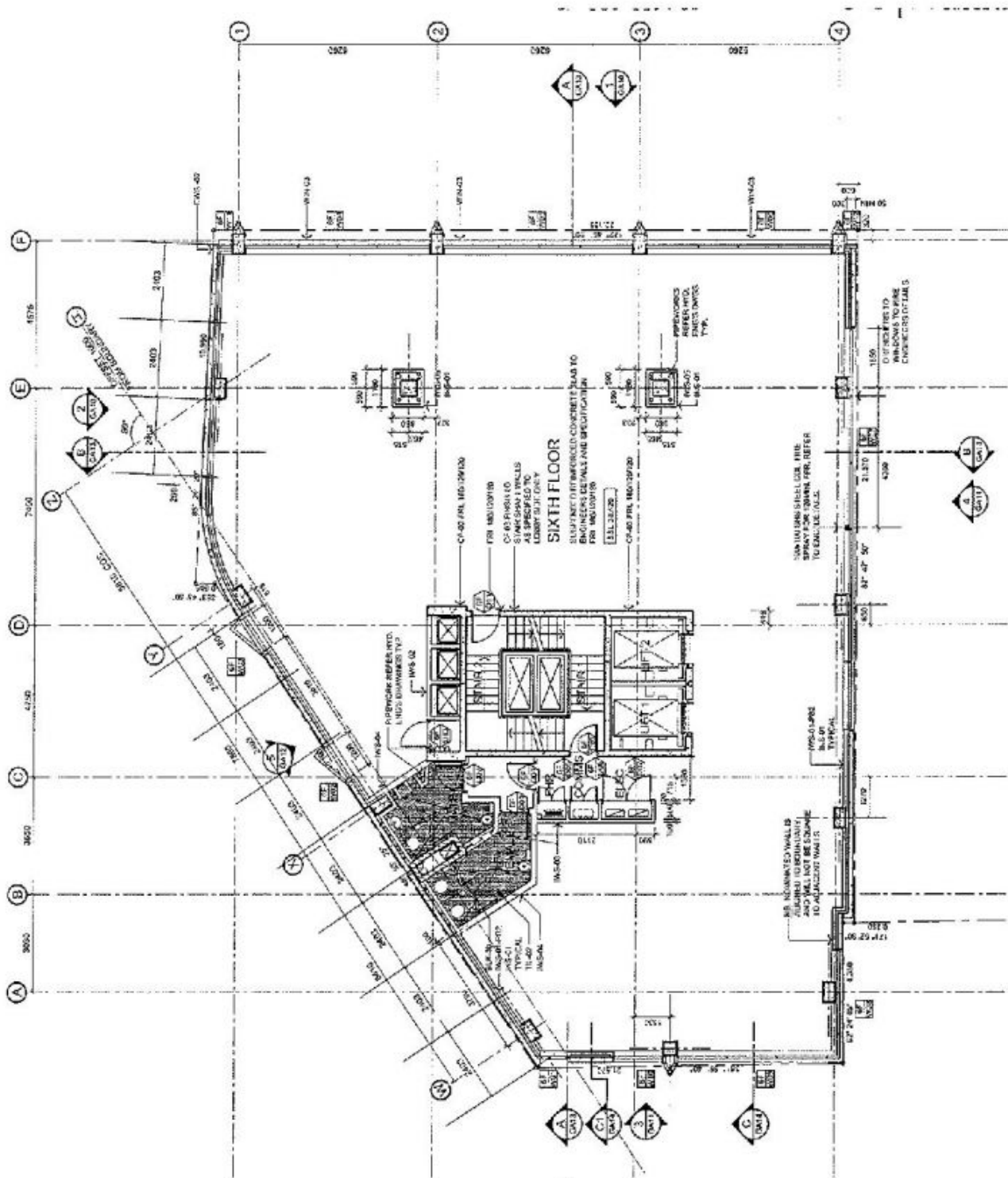

2 SIXTH FLOOR PLAN *NTS*
 RI 35.420 SSI
 FOR DETAILS, REFER TO 0019