

Level 4/311 Castlereagh Street Sydney NSW

- *Approx. 101m2
- *Fully furnished, quality fitout
- *Access to landscaped court yard with outside seating
- *Reception, size adjustable room, open plan working space
- *Internal kitchennette
- *Next to lift, great exposure
- *Individual air conditioning

- Price** : Contact Agent
- Building Size** : 101 sqm
- Land Size** : 101 sqm
- View** : <https://www.drakeproperty.com/lease/nsw/sydney-city/sydney/commercial/offices/6299082>

Campbell Tower, 311 Castlereagh Street, is located on the western side of Castlereagh Street on the corner of Castlereagh and Campbell Streets. It is well serviced by Museum and Central train stations and also Museum bus stations which are within walking distance and only a short distance from Chinatown and the Law courts.

The commercial foyer is serviced by two lifts with access from Castlereagh Street. Other Building Amenities include;

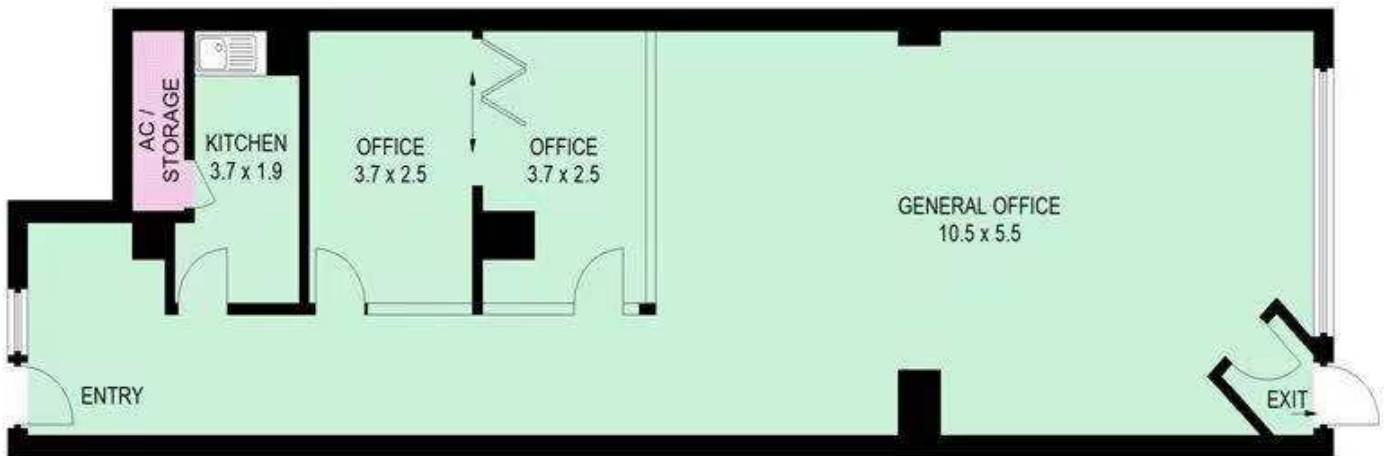

LEVEL 4

Suite 465, 311 Castlereagh Street, Haymarket



This information is not to be relied upon.

It is strictly for marketing & illustration purposes only.

All measurements are approximate. Not to scale.

No liability accepted.

You must rely on your own inquiries and seek advice from your solicitor. (ID 729990)