



Level 4/29/301 Castlereagh Street Sydney NSW

- ? Approx. 41sqm
- ? One partitioned room, open spare and reception area
- ? Close to Central, Museum and Town Hall train stations, Local Courts, World Square & China Town
- ? Surrounded by popular cafes and restaurants

Price : Contact Agent
Building Size : 41 sqm
View : <https://www.drakeproperty.com/lease/nsw/sydney-city/sydney/commercial/offices/7557437>

The property is located on the western side of Castlereagh Street approx. 30m from the corner of Castlereagh St and Goulburn St.

The property is well serviced by Museum and Central train stations and also Museum bus stations which are within walking distance and only a short distance from Chinatown and the Family Law courts.

For more Information, please contact David on 0492 92 97 91.

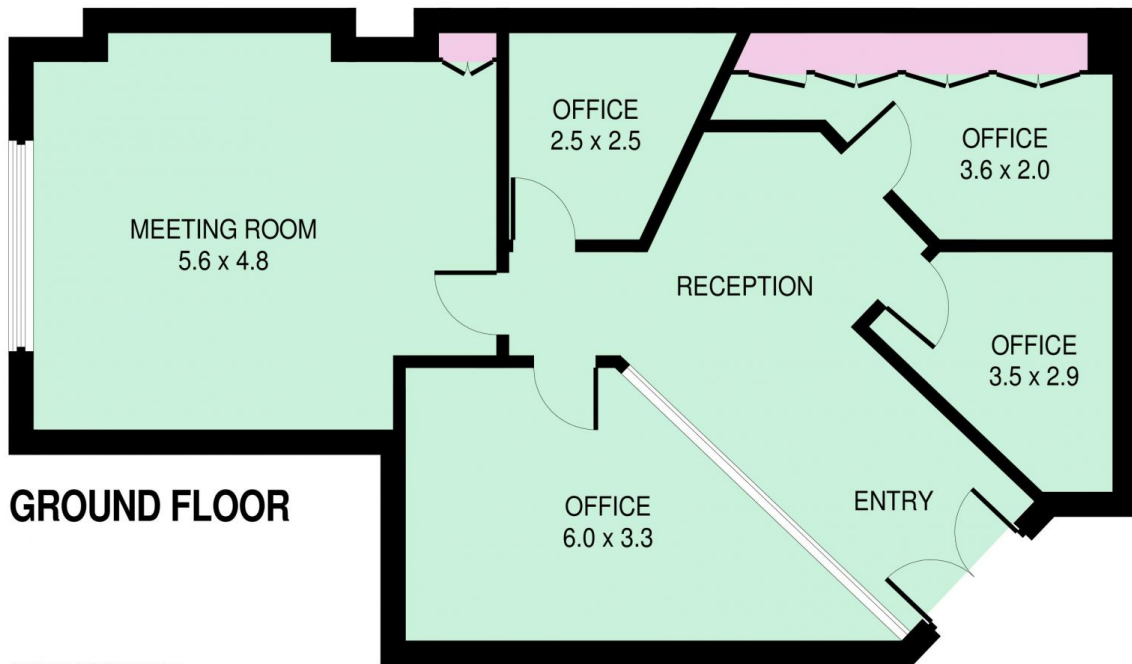

APPROXIMATE
GROSS INTERNAL AREA = 85 SQM

Suite 10, 301 Castlereagh Street, Haymarket

This information is not to be relied upon.
It is strictly for marketing & illustration purposes only.
All measurements are approximate. Not to scale.
No liability accepted.

You must rely on your own inquiries and seek advice from your solicitor.(ID 629615)

